

DeCELLE

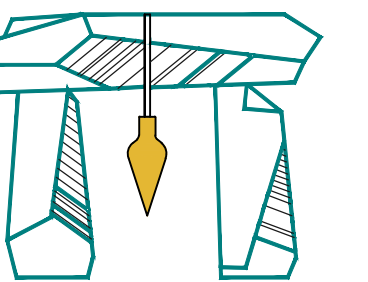

BURKE
& Associates, Inc.

1266 Furnace Brook Parkway, Suite 401 Quincy, MA 02169
(617) 405-5100 (O) (617) 405-5101 (F)

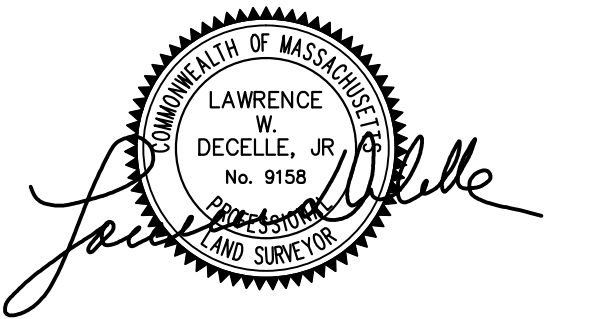

GENERAL NOTES:

1. THIS PLAN IS TO ESTABLISH THE AREA OF AGRICULTURAL AND RESIDENTIAL USE OF THE PARCELS KNOWN AS THAYER NURSERY LOCATED AT THE CORNER OF HILLSIDE AND FOREST STREETS ONLY. THE ASSESSORS PARCELS ARE MAP N BLOCK 12 LOTS 1A, 1B AND 1C.

PROJECT TITLE & LOCATION:

PLAN OF LAND
IN
MILTON, MA

270 HILLSIDE STREET

PLAN TITLE:

EXISTING CONDITIONS

PREPARED FOR:

THAYER NURSERY
270 HILLSIDE STREET
MILTON, MA 02186

DATE: DECEMBER 22, 2014

REVISED: FEBRUARY 6, 2015

REVISED: JUNE 15, 2015

JOB NUMBER: 2014.004

SHEET 1 OF 3

40 20 0 40 80
SCALE: 1"=40'



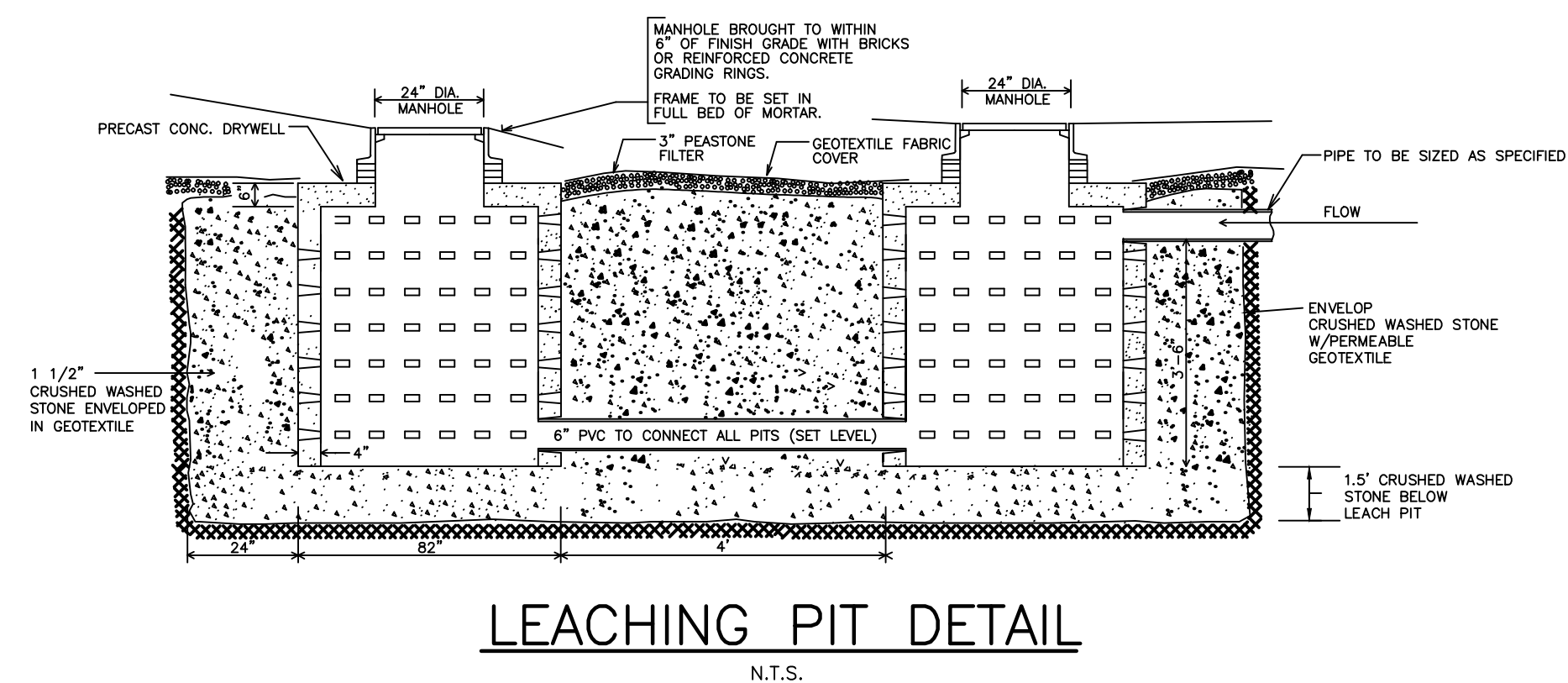
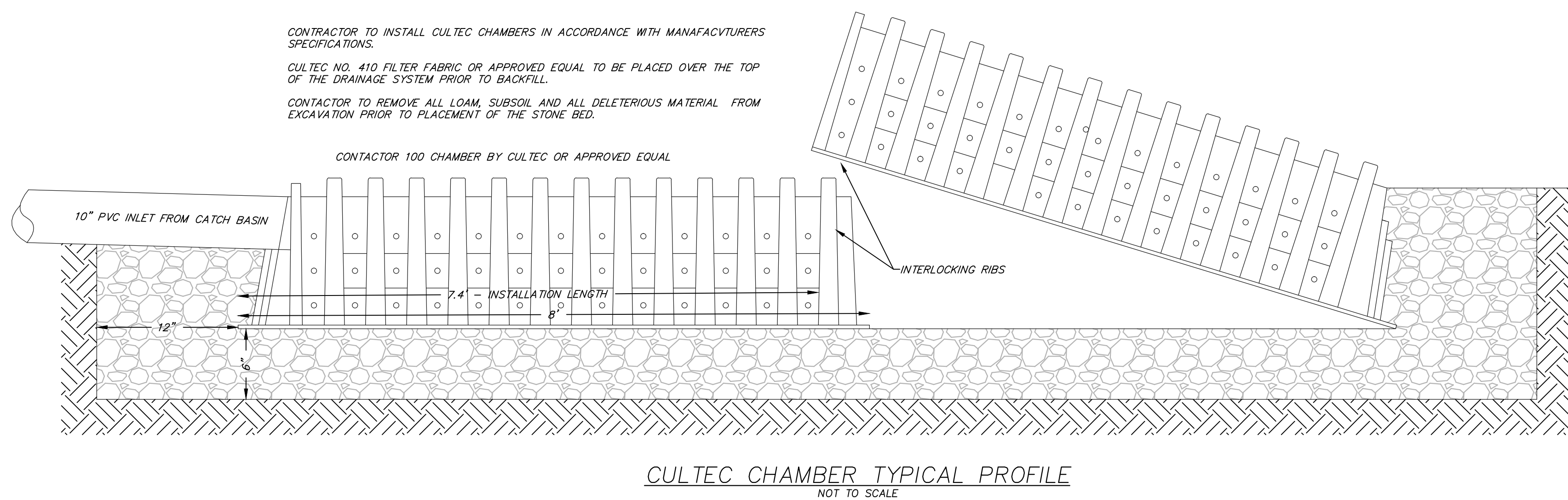
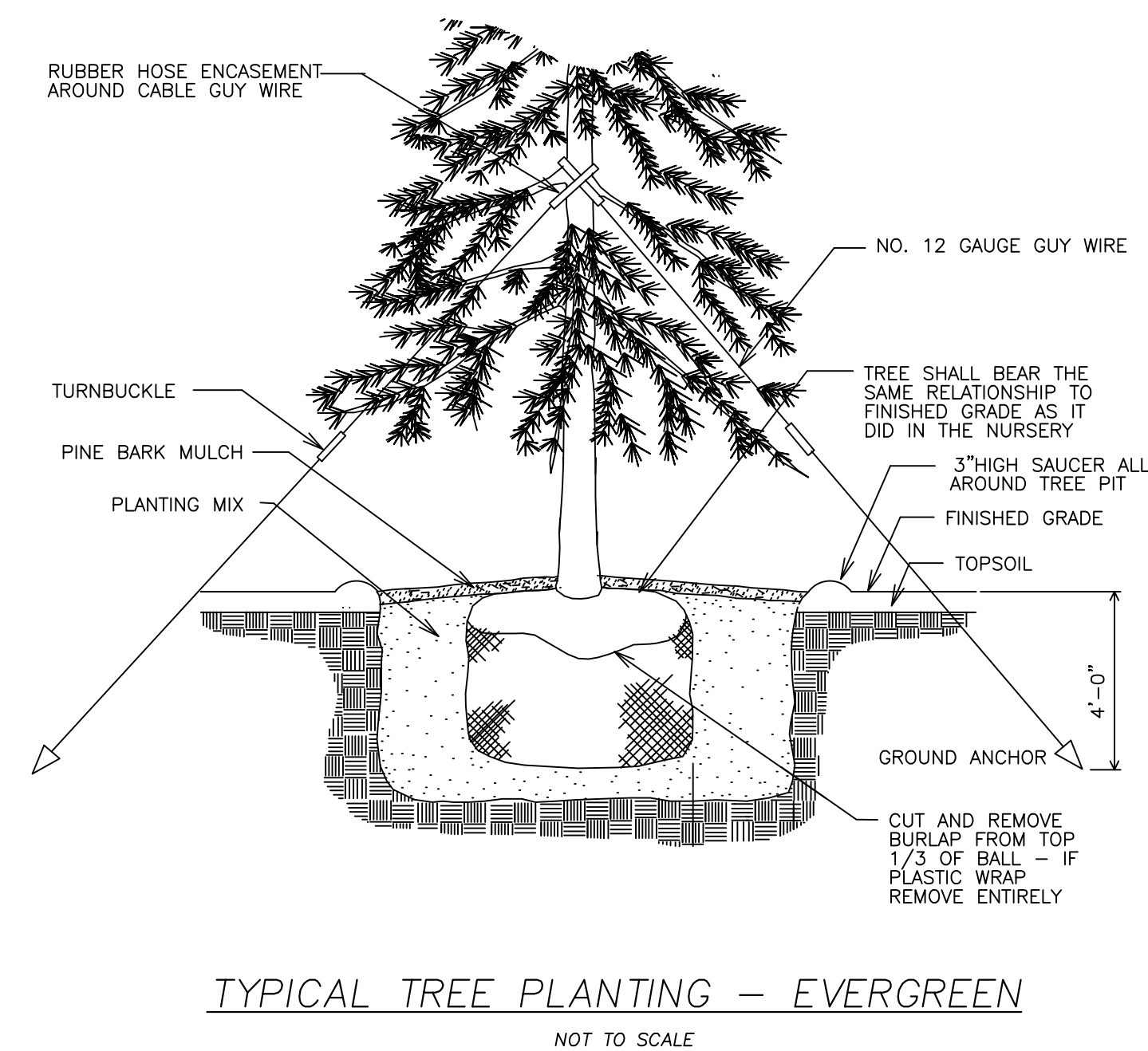
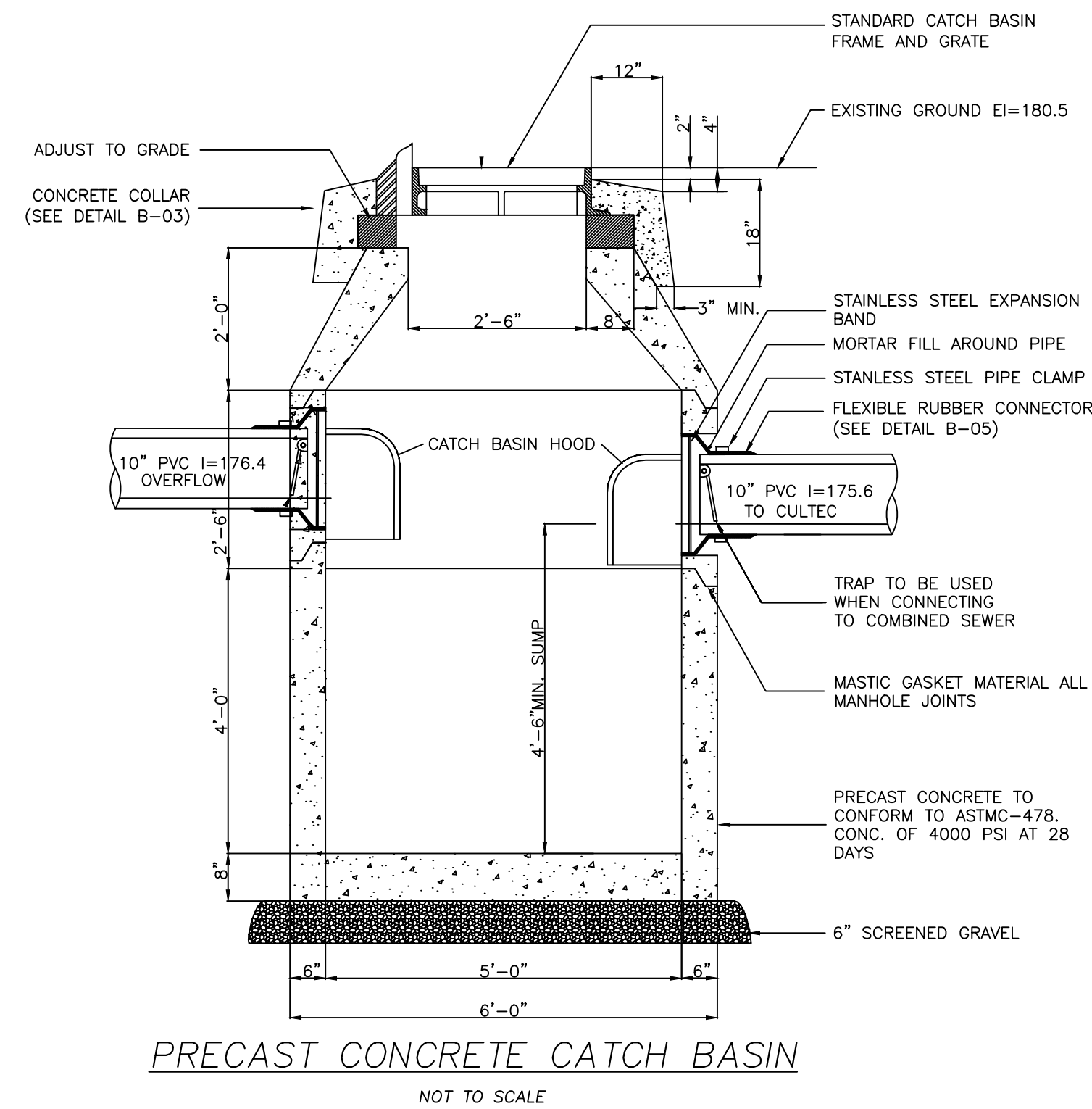

DeCELLE

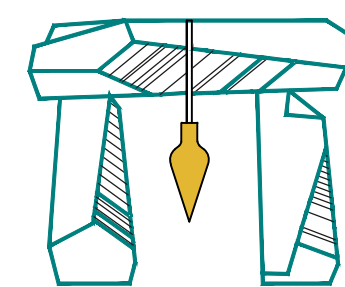

BURKE
& Associates, Inc.

1266 Furnace Brook Parkway, Suite 401 Quincy, MA 02169
(617) 405-5100 (O) (617) 405-5101 (F)

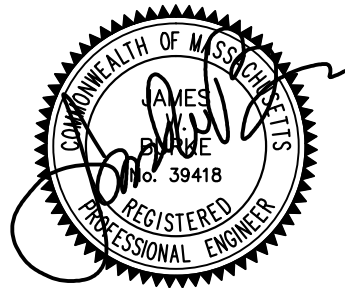

JAMES W BURKE, PE DATE

- GENERAL NOTES:
1. THIS PLAN IS PROPOSED TO MEET THE REQUIREMENTS SET FORTH IN SECTION 10 OF THE GENERAL BYLAWS.
 2. THIS PLAN IS THE RESULT OF AN ON THE GROUND SURVEY PERFORMED BY THIS OFFICE IN FEBRUARY AND OCTOBER OF 2014.
 3. THE LOCATION OF EXTERIOR LIGHT FIXTURES ARE IN RED ON THE PROPOSED CONDITIONS PLAN. FOR MORE INFORMATION, REFER TO THE DOCUMENT TITLED SUPPLEMENT TO APPLICATION FOR SPECIAL PERMIT FOR LANDSCAPE BUSINESS USE.
 4. THE LOCATION OF BUSINESS SIGNS ARE SHOWN IN ORANGE ON THE EXISTING AND PROPOSED CONDITIONS PLANS.

PROJECT TITLE & LOCATION:

PLAN OF LAND
IN
MILTON, MA

270 HILLSIDE STREET

PLAN TITLE:
DRAINAGE DETAIL SHEET

PREPARED FOR:

THAYER NURSERY
270 HILLSIDE STREET
MILTON, MA 02186

DATE: OCTOBER 22, 2014
REVISED: FEBRUARY 25, 2015
REVISED: JUNE 15, 2015

JOB NUMBER: 2014.004 SHEET 3 OF 3
40 20 0 40 80
SCALE: 1"=40'